



ELITE i

① EN 20:1 Implant Handpiece

① ES Pieza de mano 20:1 para implantología

① FR Pièce à main 20:1 pour l'implantologie

INSTRUCTIONS FOR USE

Read before use. Keep in a safe place for future reference.



CAUTION: Federal (US) law restricts this device to sale by or on the order of a licensed professional

**Caution**

- Before each use, check for vibration, noise, and overheating. If any abnormalities are observed, stop using immediately and contact Henry Schein ProRepair.
- Do not drop, hit or subject to excessive shock.
- Sterilization is required before first use.
- Do not wipe or immerse in acidic solutions. The user is responsible for correct operation, maintenance, and inspection.
- Do not disassemble or alter the motor, attachments or heads.
- Never operate handpiece without a rotary instrument.

SPECIFICATIONS

Description	Maxima Elite i	Maxima Elite iL
Item code	570-1147	570-1148
Gear Ratio	20:1	20:1
Speed	250 - 2500 rpm max.	250 - 2500 rpm max.
Rotary Instruments	Ø2.35 (ISO1797-1)	Ø2.35 (ISO1797-1)

Connecting / Disconnecting Attachments (Fig. 1)

Caution

- Make sure the attachment sits flush on motor. If not, repeat connecting process.
- Do not connect or disconnect attachments until drive motor has stopped completely.

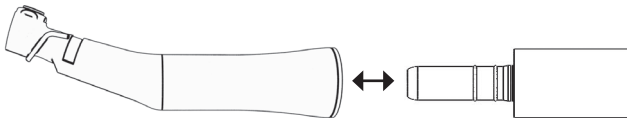

Fig. 1

Connecting

1. Slide the attachment over the nose portion of the motor until it clicks.
2. Attachment is secure.

Disconnecting

1. Pull attachment away from motor to separate.

Inserting and Removing Rotary instrument (Fig. 2)

Inserting rotary instrument

1. Press push-button and insert rotary instrument into head until it stops.
2. Release pressure on button; rotary instrument should now be secure.
3. Firmly tug on rotary instrument to ensure that it is properly secured.

Removing rotary instrument

1. Press push-button on end cap with thumb.
2. Pull to remove rotary instrument.

Installing and removing internal irrigation clip

Installing (Fig. 3)

1. Place needle through hole in head cap
2. Slide clip into channel on handpiece body

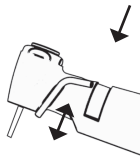

Fig. 2

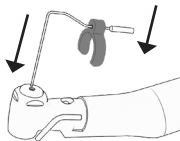

Fig. 3

Removing (Fig.4)

1. Grasp on either side and pull straight back, do not pull on irrigation needle as it may cause damage.

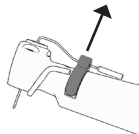

Fig. 4

CLEANING AND LUBRICATION

Handpiece Maintenance (Fig. 5)

Note: Cleaning and lubrication is required before each sterilization cycle.

1. Remove rotary instrument.
2. Detach handpiece from motor.
3. Fit E-type spray adapter onto universal cap nozzle of Henry Schein® Maxima HP Spray (112-6928)
4. Insert spray adapter completely into back of handpiece and hold it in place (Fig. 5).
5. Dispense spray for 1-2 seconds, then re-attach hp to motor while holding upside down, run handpiece to purge cleaner/lubricant.
6. Repeat steps 4 and 5 until cleaner/lubricant expelled from head is clear.
7. Wipe excess cleaner/lubricant from handpiece with dry, lint-free cloth.

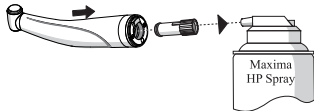

Fig. 5

Chuck Maintenance (Fig. 6)

Note: It is recommended that the push-button chuck be cleaned every 3 - 4 maintenance cycles.

1. Remove rotary instrument.
2. Detach handpiece from motor .
3. Fit chuck adapter onto universal cap nozzle of Henry Schein® Maxima HP Spray.
4. Insert spray adapter into chuck and dispense spray for 1 - 2 seconds (Fig. 6).
5. Work chuck mechanism to distribute cleaner/lubricant by repeatedly pressing button.
6. With push button depressed, insert and remove rotary instrument several times to break-up remaining debris.

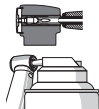

Fig. 6

Cleaning Light Guide (Fig. 7)

1. Clear light guide surfaces (A) of particulates by spraying with air syringe.
2. Wipe light guide surfaces with a soft cloth or cotton swab damped with alcohol.

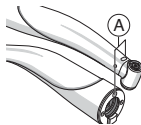

Fig. 7

Cleaning and Lubrication with Maxima XTEND Handpiece Maintenance Machine

Handpiece maintenance

Note: Cleaning and lubrication is required before each sterilization cycle.

1. Remove rotary instrument.
2. Detach handpiece from motor.
3. Attach handpiece to appropriate connector in Henry Schein® Maxima XTEND® Maintenance Machine (570-0072).
4. Run maintenance cycle. See Maxima XTEND instructions for further information.
5. Remove handpiece from Maxima XTEND Maintenance Machine after cycle completes.
6. Wipe excess cleaner/lubricant from handpiece with dry, lint-free cloth.

Chuck maintenance

Note: It is recommended that the push-button chuck be cleaned every 3 - 4 maintenance cycles.

1. Remove rotary instrument.
2. Place chuck opening against tapered end of chuck cleaning nozzle.
3. Press start. Keep handpiece in place until beep sounds indicating that cleaning cycle is completed. See Maxima XTEND instructions for additional information.



STERILIZATION



- Sterilization is required before first use.
- Sterilize by steam autoclave after each patient use.
- Do not use ultrasonic bath, boiling water or chemicals to clean.
- Do not autoclave at temperatures that exceed 275° F (135° C).
- Do not autoclave together with other instruments.
- Do not use dry heat sterilization.
- Wear appropriate personal protective equipment during sterilization and maintenance process. This should include eye protection and gloves.
- Keep in sterilization pouch until ready to use.

1. Wipe handpiece with damp cloth.
2. Place handpiece in sterilization pouch and seal. Bag handpieces individually.
3. Steam autoclave for a minimum of 15 minutes at 270° F (135° C). Let autoclave cycle completely. Do not remove before handpiece is completely cool and pouch is dry.

REPLACEMENT PARTS & ACCESSORIES

xxx-xxxx Irrigation Clip

570-0086 E-Type Adapter

570-0072 Maxima Xtend Handpiece Maintenance Machine

112-6928 Henry Schein® Maxima HP Spray

112-6934 E-Type Nozzle Adapter

SERVICE

For items that require service, including warranty service, please send to Henry Schein ProRepair.

Henry Schein ProRepair

620 S. Placentia Ave.

Placentia, CA 92870 USA

Phone: +1-714-579-0175

Fax: +1-714-579-0186

Email: prorepair@henryschein.com

WARRANTY

These products are designed for use in a dental office and this warranty is not applicable to other uses. The products are warranted against manufacturing defects in materials and workmanship for 1 year from date of purchase.

Henry Schein® will repair or replace products at its sole discretion. This warranty shall be limited to replacement or repair

of the products or their parts and shall not extend to any other claims, including but not limited to loss of profit, cost of removal or replacement, incidental or consequential damages or other similar claims arising from use of this product. Damage to products resulting from acts of God, faulty installation, misuse, tampering, accident, abuse, negligence, alterations, unauthorized repairs or problems unrelated to materials and workmanship are not covered by this warranty.

Distributed by:

HENRY SCHEIN INC.

135 DURYEA ROAD

MELVILLE, NY 11747 USA

Made In South Korea

Fabricado en Corea del Sur

Fabriqué en Corée du Sud

M0085 2019/05